



IMPACT Max

Maximum security. Maximum potential. Maximum results.

Delivering a truly intuitive and collaborative experience, IMPACT Max is an interactive screen with unlimited possibilities. Combines high-quality design, functionality, durability, native screen sharing and 4K resolution.



Quick Launch Menu for instant teaching tools
Your most commonly used apps are available with one touch and are easily accessible via the Quick Launch Menu.

Available in a range of sizes
65" | 75" | 86"

Software included at no extra cost

CLEVER® LIVE  **CLEVERSHARE®**  **CLEVERMDM®**

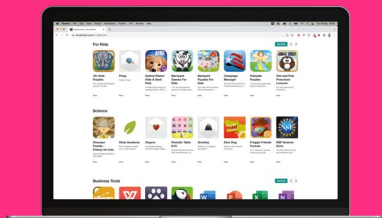

 **CLEVERSTORE®**

Choose from hundreds of apps at no extra cost. Cleverstore has apps in multiple languages and for all age groups and subjects. No adverts, no in-app purchases, no hassle.

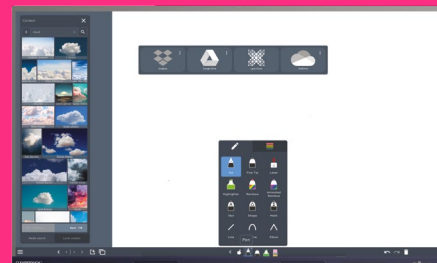

 **LYNX**
whiteboard

LYNX Whiteboard is a free-to-use lesson building app, enabling student collaboration. The most dynamic, intuitive user experience of any whiteboard

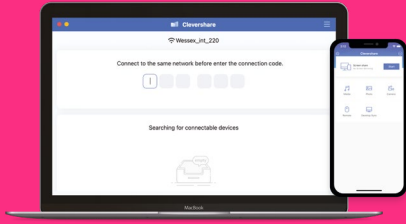

Any device can download the Clevershare app and connect instantly by typing in the code on the Clevertouch screen. Clevershare App is free to download and compatible with Android, Windows, iOS, and Chrome devices.

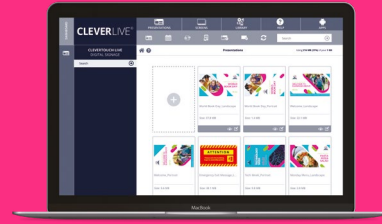

CleverLive controls all of your Clevertouch products from one central place. It is the software platform that enables the creation, deployment and management of content deployed across one or multiple displays. CleverLive is a cloud management platform and is compatible with any device.

Key Features



Designed for blended learning



LYNX Whiteboard lesson creation app



Cleverstore free app store



Clevershare screen mirroring



Remote management MDM



Customise your home screen



Full digital signage capabilities



Compatible with Google Classroom and Microsoft 365



Connect your Cloud accounts to work from anywhere



Built-in array microphone - all lessons can be recorded with sound



Latest generation USB-C with charging and hardware optimization



2 x 20W speakers for room-filling sound



IMPACT Max is an Award-Winning Clevertouch Interactive Display.

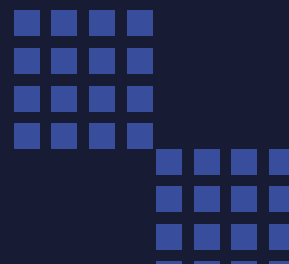

IMPACT Max Specifications

Display

Diagonal Size	65" 4K, 75" 4K, 86" 4K
Screen Type	TFT LCD - Direct LED Backlight
Aspect Ratio	16:9
Display Colours	1.07 Billion (10 bit)
Resolution	4K UHD (3840x2160 @60Hz)
Response Time	5ms
Refresh Rate	60Hz
LCD Viewing Angle	178°
Brightness	450 cd/m2
Contrast Ratio	65" 4000:1 75" 5000:1 86" 4000:1
Dynamic Contrast Ratio	65" 6000:1 75" 6000:1 86" 6000:1
Glass Hardness	Tempered Glass - Mohs Level 7
Glass Thickness	3mm
Glass Type	Low Parallax 1mm Air Gap - Heat tempered
AntiGlare Glass	Yes
Main Board	Amlogic T982 (SoC)
Life of Screen	50,000 Hours
NTSC	65" 72% 75" 72% 86" 68%

Interactivity

Writing Technology	High Precision IR Technology
Continuous Touch Points	20
Touch Resolution	32768x32768px
Response Time	≤5ms
Touch Accuracy	1mm
Minimum Object Size	3mm
Touch Tool	Finger, passive pen, opaque objects
Simultaneous Writing	Yes
Ink In Tools	Yes - Lynx
Pens Included	2
Pen Type	Dual Recognition Stylus Super Cool Stylus
Pen Holder	Integrated magnetic pen holders
Pen Tip Diameter	3mm/7mm
Pen & Touch Differentiation	Yes
Pen Identities	2
Palm Rejection	Yes
Annotation Over Any Source	Yes
Classroom Essential Apps	Includes Whiteboard, Annotate, Timer, Media Players, Browser, PDF Reader, Screen Record, Spinner, Voting, Maths Tools
Compatibility*	Windows 10, Linux, Mac, Android, Chrome
Tracking Rate	≥1m/s
Scan Rate	200Hz
Gestures & Edge Swipes	Windows Supported, OSX With additional Driver

Connectivity

OPS Slot	1 - Intel Spec 80Pin
HDMI In	3
HDMI Out	1
USB-A 2.0	1
USB Touch (type B)	2
USB A 3.0 (Faster Data Transfer)	4
USB C (Video, Audio & Touch)	1 (supports 65W charging)
LAN In (RJ45)	1 GB
LAN Out (RJ45)	1
RS-232	1
Wake-on-Lan	Yes
Wireless Adapter 2.0 + WAP	Yes
Clevertouch WiFi Module	Yes
Bluetooth	Yes 5.0
Displayport In	No
VGA In	1
Audio In	1
Optical Out	1
Headphone	1 (3.5mm)
Total touch out ports	2
NFC Reader / Writer	Optional Extra
Camera	Optional Extra
Proximity Sensor	No
Array Mic	6
WiFi	IEEE 802.11a/b/g/n/ac/ax with 2 × 2 MIMO (hotspot only) (both 2.4 and 5 GHz bands)
WiFi Speed	Capable of speeds up to 433Mbps

Computing

Operating System	Android 11
System Version	LUX 11
RAM	8GB
Internal Storage	64GB
CPU	Quad Core A55
GPU	Mali G52MP2
Android Resolution	4K
Android Module Slot	No
System Architecture	32-bit
Integrated LUX UI	Yes

Power

Power Requirements	100-240V ~ 50/60Hz
Power Consumption (Standby)	≤0.5W
Ultra Quiet Fanless Design	Yes
Power Consumption	65" 178 Watts 75" 183 Watts 86" 195 Watts

IMPACT Max Specifications

Audio

Dual Front Facing, Bass Enhanced Speakers	2 x 20W
Audio Out	Yes
SPDIF / Fibre	Yes
Sound Channel	2
Line Array Microphone	Yes
Super Wide Sound	No
Amplifier Power	95W

Operating & Storage Environment

Operating Temperature	0° to 40°
Storage Temperature	-20° to 60°
Operating Humidity	10% to 90% RH
Storage Humidity	10% to 90% RH
Altitude	Below 5000 metres

Physical Spec

Panel Dimensions	65" 1489x906x87mm 75" 1709x1013x88mm 86" 1957x1168x88mm
Packed Dimensions	65" 1628x208x1005mm 75" 1863x225x1148mm 86" 2110x225x1291mm
Net Weight	65" 35.9kg 75" 47.75kg 86" 62.9kg
Packed Weight	65" 46.25kg 75" 61.9kg 86" 80.6kg
VESA Mount Point	65" 600x400mm 75" 800x400mm 86" 800x600mm

Inside your Clevertouch Box

What's In The Box	(1) Clevertouch IMPACT MAX (1) 1.5M Length HDMI Cable (1) 3M Length USB cable (A-B) (1) 1.5M USBC Cable (1) 3M Regional Power Cable (1) Remote Control (2) Batteries for Remote Control (2) Dual Recognition Stylus (1) User Guide (1) Quick Install Guide (1) Clevertouch WiFi Module
-------------------	--

IMPACT Max Built-In Features

LYNX™ App With Online Lesson Planning	Yes
Cleverstore™ App Store For Education	Yes
Embedded Digital Signage	Yes
Clevershare™ Mirroring Any Device To The Board	Free for the life of the screen (touch back)
Integrated Personalised Accounts Profiles	Yes
Cloud Account Access	OneDrive, Google Drive, LYNX Cloud
Embedded Room Booking	Yes
Whiteboard Annotation	Yes
Email Out Direct From Touchscreen	Yes
Scan QR Code For Saving Work	Yes
Alerts and Announcements	Yes
Over-the-Air Updates	Yes
Remote Management Of Touchscreens (MDM)	Yes - 12 month license
CleverLauncher™	Yes
LynxShare™	Yes
LynxCloud™	Yes

Warranty

Warranty term and upgrade options vary by region. Contact your local reseller or distributor for information and visit clevertouch.com/about/warranty

Compliance & Certification

Regulatory Certification	CE, FCC, UL, Energy Star & EEC
--------------------------	--------------------------------



Support

For all Clevertouch products, visit: support.clevertouch.com

Statement

Size and weight vary by configuration and manufacturing process, please refer to the actual product. The product images are for illustrative purposes only and may slightly differ in appearance, colour, size, etc. from the actual product. The description, illustrations, etc. in this document may subject to change in accordance with the latest product specification and performance. Should the above-mentioned change in the document become necessary, the document may be updated without written notice.